

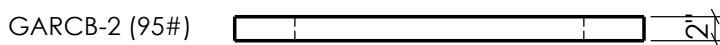

2215 E. BROOKLYN AVE - SPOKANE, WA 99217  
TOLL FREE 1-800-888-4573  
(509) 325-4573 FAX (509) 325-5098  
SPOKANE - LEWISTON - YAKIMA  
[www.wilbertprecast.com](http://www.wilbertprecast.com)

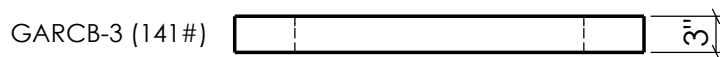
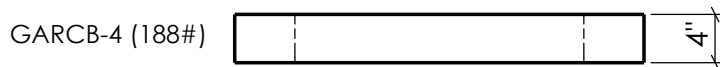
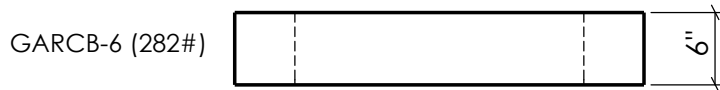
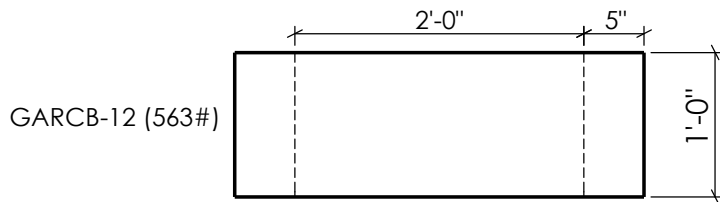
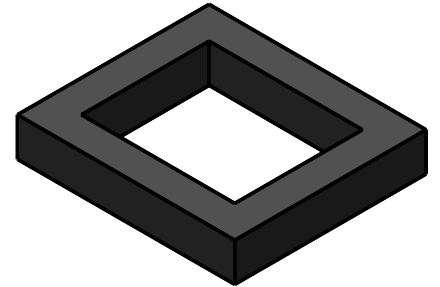
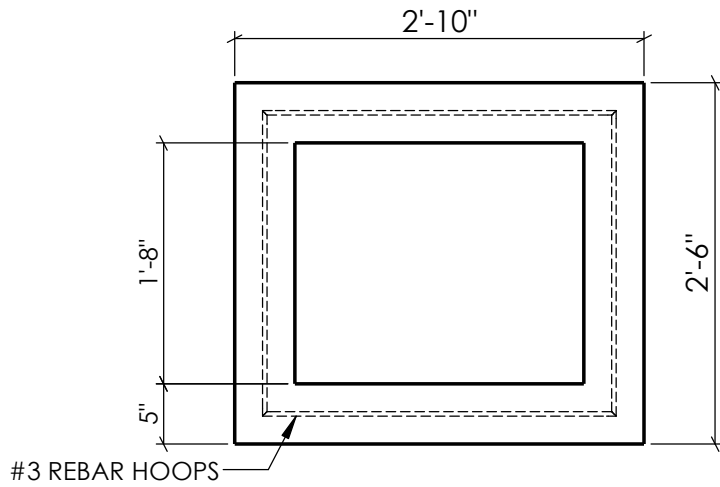

**NOTES:**  
~MEETS OR EXCEEDS  
THE REQUIREMENTS OF  
ASTM C-478 / AASHTO  
M-199 & ASTM C-443

## RISER "S" FOR INLET

**MODEL #:**

GARCB-12 / GARCB-6 /  
GARCB-4 / GARCB-3  
GARCB-2